



Electric Removable Griddle  
Gril électrique à plaque amovible

User Guide / Notice d'emploi

**CKSTGRRM25-033**



*Safety*  
*Sécurité*



*How to use*  
*Mode d'emploi*



*Cleaning*  
*Nettoyage*



*Warranty*  
*Garantie*

# IMPORTANT SAFEGUARDS

When using electrical appliances, basic safety precautions should always be followed, including the following:

1. Read all instructions before using.
2. Do not touch hot surfaces. Use handles or knobs.
3. To protect against electrical shock, do not immerse HEATING BASE and cord in water or other liquids.
4. Close supervision is necessary when any appliance is used near children. This appliance is not to be used by children.
5. Unplug from outlet when not in use and before cleaning. Allow to cool before putting on or taking off parts, and before cleaning the appliance.
6. Do not operate any appliance with a damaged cord or plug or after the appliance malfunctions or has been damaged in any manner. Call Customer Service (see warranty) to return for examination, repair, or adjustment.
7. The use of accessory attachments not recommended by manufacturer may cause injuries.
8. Do not use outdoors.
9. Do not let cord hang over edge of table or counter, or touch heated surfaces.
10. Do not place the assembled appliance or GRIDDLE PLATE on or near a hot gas or electric burner. Do not place the assembled appliance in a heated oven.
11. Extreme caution must be used when moving appliance containing hot oil or other hot liquids.
12. Do not operate the griddle unless fully assembled. Place GRIDDLE PLATE on HEATING BASE first, then plug cord into wall outlet.
13. Do not use appliance for other than intended use.
14. To disconnect, prior to removing GRIDDLE PLATE from HEATING BASE, turn the temperature control knob to OFF to shut off griddle and remove plug from wall outlet.
15. Oven mitts are required when handling the GRIDDLE PLATE or to remove cooked food from the GRIDDLE PLATE.

**THIS UNIT IS INTENDED FOR HOUSEHOLD USE ONLY.**



# SAVE THESE INSTRUCTIONS

**THIS APPLIANCE IS FOR HOUSEHOLD USE ONLY.** No user-serviceable parts inside. Do not attempt to service this product. A short power supply cord is provided to reduce the hazards resulting from entanglement or tripping over a longer cord. AN EXTENSION CORD MAY BE USED WITH CARE; HOWEVER, THE MARKED ELECTRICAL RATING SHOULD BE AT LEAST AS GREAT AS THE ELECTRICAL RATING OF THE GRIDDLE. The extension cord should not be allowed to drape over the counter or tabletop where it can be pulled on by children or tripped over.

To reduce the risk of electrical shock, this appliance has a polarized plug (one blade is wider than the other). This plug fits a polarized outlet only one way. This is a safety feature intended to help reduce the risk of electrical shock. If the plug does not fit fully into the outlet, reverse the plug. If it still does not fit, contact a qualified electrician. Do not attempt to defeat this safety feature.

**ELECTRIC POWER:** If electric circuit is overloaded with other appliances, griddle may not operate properly. Griddle must be operated on a separate circuit from other operating appliances.

**CAUTION:** Some countertops are more sensitive to heat, use care not to place griddle on surfaces where heat may cause damage.

Thank you for purchasing the OSTER™ Electric Removable Griddle. Before you use this product for the first time, please take a few moments to read these instructions and keep it for reference. Pay particular attention to the Safety Instructions provided. Please review the product service and warranty statements. To learn more about Oster™ products, please visit us at [www.oster.ca](http://www.oster.ca) or call us at 1-800-667-8623.



# LEARNING ABOUT YOUR ELECTRIC GRIDDLE

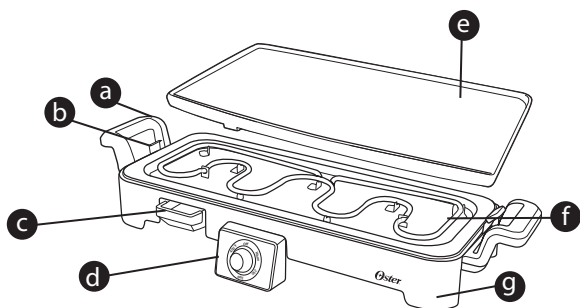

**a** Handle

**b** Griddle Plate Latch

**c** Drip Tray

**d** Temperature  
Control Panel

**e** Removable Griddle Plate

**f** Heating Element

**g** Griddle Base





## HOW TO:

### Before first use

**Wash the Removable Griddle Plate in warm soapy water or in the dishwasher and dry completely.**

**CAUTION:** Do not immerse Heating Base in water or other liquids.

- 1 Set the griddle on a flat, dry, heat resistant surface.
- 2 Condition the non-stick cooking surface with vegetable oil, wiping off any excess with a paper towel.
- 3 Insert the Drip Tray into guides under the front of the griddle.

- 4 Make sure that the Griddle Plate is sitting securely on the Heating Base. If the Griddle Plate is not secure on the Heating Base, the product may not function properly. Make

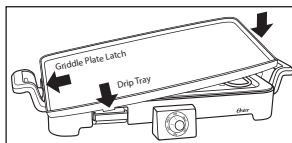

Figure A

sure that the griddle plate is locked securely into the griddle plate latches located on the base. (See Figure A)

**NOTE:** Position the griddle plate with the taller edge facing forward and the drip hole positioned above the drip tray.

- 5 Make sure Griddle is in the "OFF" position and drip tray is properly inserted. Plug unit into standard 120 V AC outlet.

**NOTE:** The Power Indicator Light will illuminate, indicating that the griddle is plugged in to a power source.

- 6 Preheat the Griddle by aligning the Temperature Control Knob indicator with the appropriate temperature setting for approximately 15 minutes prior to use.

**NOTE:** During cooking, the Power Indicator Light will remain on.

- 7 The Temperature Control also has a "Keep Warm" setting if there is pre-cooked food that you would like to remain warm.

**NOTE:** WARM is recommended for keeping already hot, fully cooked food at the perfect serving temperature. We do not recommend using the WARM setting for more than 4 hours.



- 8** Do not remove the griddle plate until it has had time to fully cool down.

**NOTE:** It may be necessary to scrape grease into the Drip Tray. Always use wooden or nylon utensils to avoid scratching the Non-Stick Cooking Surface.

**CAUTION:** Grease may be hot!

**NOTE:** When cooking consecutive batches of bacon or other high fat foods, it may be necessary to empty the Drip Tray to avoid grease overflowing onto the countertop.

**NOTE:** Some countertops are more sensitive to heat. Use care not to place the Griddle on surfaces where heat may cause damage.

## Cooking Time and Temperature

FOOD	TEMP.*	TIME	DIRECTIONS
EGGS, fried	300° F / 149°C	3 to 5 min.	Turn halfway into cooking time.
BACON	350° F / 177°C	8 to 12 min.	Turn often.
SAUSAGE	350° F / 177°C	20 to 30 min.	Turn halfway into cooking time.
FRENCH TOAST	350° F / 177°C	6 to 10 min.	Turn halfway into cooking time.
HAMBURGER	350° F / 177°C	8 to 14 min.	Turn halfway into cooking time.
HAM SLICES	350° F / 177°C	14 to 18 min.	Turn halfway into cooking time.
SANDWICHES	350° F / 177°C	6 to 10 min.	Butter outside and brown both sides.
PORK CHOPS	350° F / 177°C	20 to 30 min.	Brown both sides, reduce temp. to 250° F. Turn halfway into cooking time.
POTATOES	350° F / 177°C	10 to 12 min.	Turn halfway into cooking time.
STEAKS			
Rare	400° F / 204°C	4 to 6 min.	Turn halfway into cooking time.
Medium	400° F / 204°C	7 to 12 min.	Turn halfway into cooking time.
Well Done	400° F / 204°C	13 to 18 min.	Turn halfway into cooking time.
PANCAKES	375° F / 191°C	2 to 5 min.	Pour batter onto griddle. When bubbles appear on top, turn.

\*Preheat Griddle until Ready Light comes on

**NOTE:** The cooking temperature and times listed in this user manual are estimates. Adjust the cooking temperature and time slightly up or down to achieve the results you prefer.





## CARE & CLEANING

**This appliance should be cleaned after every use.**

**Griddle is hot. Handle carefully.**

- 1 When cooking is complete, turn the temperature control knob to the "OFF" position. Unplug the cord from the outlet and allow unit to cool before cleaning.
- 2 Remove the Drip Tray and discard its contents.

**CAUTION:** Grease in Drip Tray may still be hot even if plate is allowed to cool. To remove Griddle Plate, push right spring latch outward until plate is released. Lift plate up and to the right.

- 3 The Griddle Plate and Drip Tray can be washed in the dishwasher or in warm soapy water with a soft cloth. Rinse and dry thoroughly.

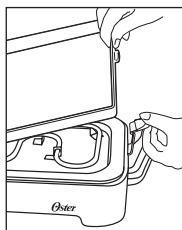

**CAUTION:** Never use or submerge Heating Base or Cord in water. Heating Base and Cord must always be completely dry before use.

- 4 With a damp cloth, clean the griddle burner base and temperature control.
  - Use only nylon, plastic, or wooden utensils with care to avoid scratching the non-stick cooking surface. Never cut food on the griddle.
  - Remove stubborn stains with plastic scouring pad and mild dishwashing liquid.

**CAUTION:** DO NOT USE steel wool. Any service requiring disassembly other than the above cleaning must be performed by an authorized Oster™ service center.





# 1 Year Limited Warranty

Sunbeam Products, Inc. doing business as Jarden Consumer Solutions or if in Canada, Sunbeam Corporation (Canada) Limited doing business as Jarden Consumer Solutions (collectively "JCS") warrants that for a period of one year from the date of purchase, this product will be free from defects in material and workmanship. JCS, at its option, will repair or replace this product or any component of the product found to be defective during the warranty period. Replacement will be made with a new or remanufactured product or component. If the product is no longer available, replacement may be made with a similar product of equal or greater value. This is your exclusive warranty. Do NOT attempt to repair or adjust any electrical or mechanical functions on this product. Doing so will void this warranty.

This warranty is valid for the original retail purchaser from the date of initial retail purchase and is not transferable. Keep the original sales receipt. Proof of purchase is required to obtain warranty performance. JCS dealers, service centers, or retail stores selling JCS products do not have the right to alter, modify or any way change the terms and conditions of this warranty.

This warranty does not cover normal wear of parts or damage resulting from any of the following: negligent use or misuse of the product, use on improper voltage or current, use contrary to the operating instructions, disassembly, repair or alteration by anyone other than JCS or an authorized JCS service center. Further, the warranty does not cover: Acts of God, such as fire, flood, hurricanes and tornadoes.

## **What are the limits on JCS's Liability?**

JCS shall not be liable for any incidental or consequential damages caused by the breach of any express, implied or statutory warranty or condition.

Except to the extent prohibited by applicable law, any implied warranty or condition of merchantability or fitness for a particular purpose is limited in duration to the duration of the above warranty.

JCS disclaims all other warranties, conditions or representations, express, implied, statutory or otherwise.





JCS shall not be liable for any damages of any kind resulting from the purchase, use or misuse of, or inability to use the product including incidental, special, consequential or similar damages or loss of profits, or for any breach of contract, fundamental or otherwise, or for any claim brought against purchaser by any other party.

Some provinces, states or jurisdictions do not allow the exclusion or limitation of incidental or consequential damages or limitations on how long an implied warranty lasts, so the above limitations or exclusion may not apply to you.

This warranty gives you specific legal rights, and you may also have other rights that vary from province to province, state to state or jurisdiction to jurisdiction.

### **How to Obtain Warranty Service**

#### **In the U.S.A.**

If you have any question regarding this warranty or would like to obtain warranty service, please call 1-800-334-0759 and a convenient service center address will be provided to you.

#### **In Canada**

If you have any question regarding this warranty or would like to obtain warranty service, please call 1-800-667-8623 and a convenient service center address will be provided to you.

In the U.S.A., this warranty is offered by Sunbeam Products, Inc. doing business as Jarden Consumer Solutions located in Boca Raton, Florida 33431. In Canada, this warranty is offered by Sunbeam Corporation (Canada) Limited doing business as Jarden Consumer Solutions, located at 20 B Hereford Street, Brampton, Ontario L6Y 0M1. If you have any other problem or claim in connection with this product, please write our Consumer Service Department.

**PLEASE DO NOT RETURN THIS PRODUCT TO ANY OF THESE ADDRESSES OR TO THE PLACE OF PURCHASE.**





For product questions contact:

Sunbeam Consumer Service

Canada : 1.800.667.8623

USA : 1.800.334.0759

[www.oster.ca](http://www.oster.ca)

©2010 Sunbeam Products, Inc. doing business as

Jarden Consumer Solutions. All rights reserved.

Imported and distributed by Sunbeam Corporation (Canada) Limited,

doing business as Jarden Consumer Solutions,

20B Hereford St., Brampton, Ontario L6Y 0M1.

Pour toute question quant à ce produit, communiquez avec le

Service à la clientèle de Sunbeam

Canada : 1 800 667.8623

États-Unis : 1 800 334.0759

[www.oster.ca](http://www.oster.ca)

©2010 Sunbeam Products, Inc. faisant affaires sous le nom de

Jarden Consumer Solutions. Tous droits réservés.

Importé et distribué par Sunbeam Corporation (Canada) Limited

faisant affaires sous le nom de Jarden Consumer Solutions,

20B Hereford St., Brampton (Ontario) L6Y 0M1.

GSC-IC0410-1267867