

Oster™

Instruction Booklet **Wine Chiller**

**MODEL FPSTBW8451,
FPSTBW8452-033**

IMPORTANT SAFEGUARDS

Safety precautions for your Oster™ Wine Chiller:

READ ALL INSTRUCTIONS BEFORE USING.

- Do not start the timer until you have filled the container with water.
- Ensure the Oster™ Wine Chiller is placed on a flat and stable surface during operation.
- Use only the AC adaptor provided with this appliance.
- Do not immerse or drop the Oster™ Wine Chiller in water or in any other liquid.
- Ensure that the water does not overflow from the rim of the unit.
- Do not allow the internal components, AC adapter and cord of the Oster™ Wine Chiller to get wet at any time.
- Do not allow any small objects to block the inlet or outlet pump.
- Always turn the control knob off before you insert or remove a plug. Remove by grasping the plug - do not pull on the cord. Always connect plug adapter to appliance before placing plug into outlet.
- Turn the power off (0) and remove the plug when the appliance is not in use and before cleaning.
- Always connect your appliance to a power outlet of the voltage (A.C. only) marked on the appliance.
- Never leave an appliance unattended while in use.
- Young children should be supervised to ensure that they do not play with the appliance.
- Do not use an appliance for any purpose other than its intended use.
- Do not place an appliance on or near a hot gas flame, electric element or on a heated oven.
- Do not place on top of any other appliance.
- Do not let the power cord of an appliance hang over the edge of a table or bench top or touch any hot surface.

IMPORTANT SAFEGUARDS (CONT.)

- For safety reasons avoid maintenance by unskilled persons, other than detailed in this manual. Appliances should always be returned to the nearest Service Center for adjustment or repair if required.
- Do not operate any electrical appliance with a damaged cord or after the appliance has been dropped or damaged in any manner. If damage is suspected, return the appliance to the nearest Service Centre for examination, repair or adjustment.

THIS UNIT IS INTENDED FOR HOUSEHOLD USE ONLY

- This appliances is for **HOUSEHOLD USE ONLY**.
- No user-serviceable parts inside.
- Do not attempt to service this product.
- Do not immerse in water or other liquid.

EXTENSION CORD USE

A short power supply cord is provided to reduce the hazards resulting from entanglement or tripping over a longer cord.

DO NOT USE AN EXTENSION CORD

SAVE THESE INSTRUCTIONS

Thank you for purchasing the Oster™ Wine Chiller. Before you use this product for the first time, please take a few moments to read these instructions and keep it for reference. Pay particular attention to the Safety Instructions provided. Please review the product service and warranty statements. To learn more about Oster® products, please visit us at www.oster.ca or call us at 1-800-667-8623.

LEARNING ABOUT YOUR WINE CHILLER

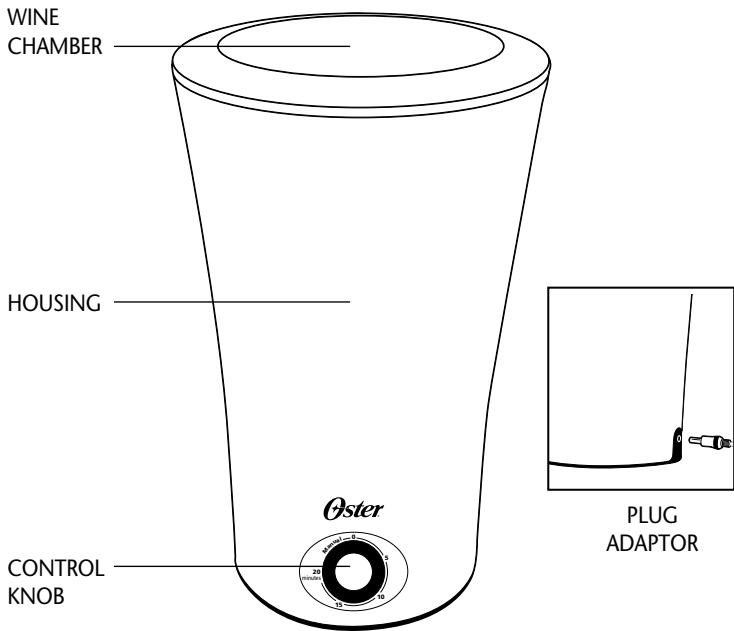

The Oster™ Wine Chiller with removable cord (FPSTBW8451 & FPSTBW8452-033) will chill wine when the unit is plugged into a power outlet. Once the wine is chilled the adaptor can be removed from the Oster™ Wine Chiller and can then be taken to the table, acting as an ice bucket to maintain the temperature of the wine.

FEATURES OF YOUR WINE CHILLER

It only takes about 8 minutes to perfectly chill a room temperature bottle of white wine (See chart on page 8 for white Zinfandel). No longer will you have to wait hours for the fridge or over 50 minutes for the freezer to chill your wine – perfect for those unexpected visitors.

1. 20 minute timer with auto off - Easy to read 20 minute timer with auto off. Allows you to chill beverages to the desired temperature – bottle after bottle.

2. Removable Cord - For added convenience once the beverage is chilled, simply remove the cord and the Oster™ Wine

Chiller can be taken to the table as an ice bucket, maintaining the temperature of the wine.

3. Removable agitating cover - the agitating cover can be removed for cleaning to enable you to retrieve any loose debris that could block the pump.

4. Continuous on - To aid in chilling continuous beverages, simply turn the timer dial to the left and the Oster™ Wine Chiller will continue chilling beverage after beverage.

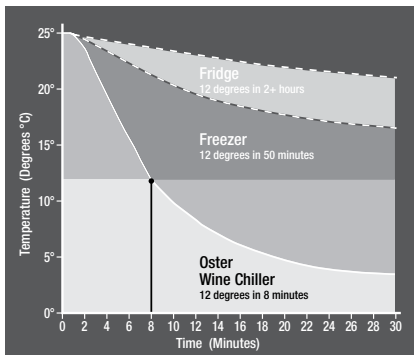

BEFORE USING YOUR WINE CHILLER

1. Place the Oster™ Wine Chiller on a dry, level surface
2. Ensure the adaptor is attached to the Oster™ Wine Chiller.
3. Plug the AC adaptor into a power outlet.

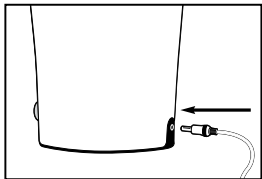

USING YOUR WINE CHILLER

To enjoy a perfectly chilled wine, follow these 3 simple steps:

Step 1 - Place the bottle to be chilled into the Oster™ Wine Chiller and ideally add two trays (or two hand fulls) of ice cubes. See the 'Recommended Time and Ice Quantities' table on page 8.

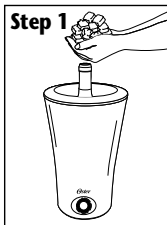

Step 2 - Using a jug, carefully pour cold tap water into the Oster™ Wine Chiller. Fill up to the water level indicator line or to the base of the neck of the bottle. Do not fill over the indicator line.

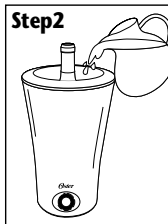

Step 3 - Finally, set the timer to the desired time. See the 'Recommended Time & Ice Quantities' table on page 8.

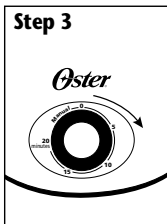

USING YOUR WINE CHILLER (CONT.)

Note: For optimum chilling, any new bottle chilled, remove the used ice cubes and water, replace with new ice cubes and fresh cold tap water. Alternatively, consecutive bottles can be chilled using the existing water, however this will slightly alter the chilling time.

Note: If the water and ice do not seem to be circulating around the bottle there may be too much ice added. Turn off the unit, remove AC adapter from power outlet and remove some of the ice then turn it back on.

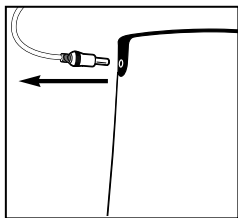

ONCE YOU HAVE FINISHED CHILLING

- When the beverage is chilled to the desired temperature, turn the control knob to “OFF” (0) remove AC adapter from power outlet and remove the adaptor from the Oster™ Wine Chiller.

- Bring the Oster™ Wine Chiller to the table or to wherever desired and use it as an ice bucket to keep the beverage cool once chilled.

- After you have finished using the Oster™ Wine Chiller, empty contents and allow the unit to dry thoroughly.

STOPPING THE OSTER™ WINE CHILLER WHILE IN USE

Should for any reason you need to reduce the time selected on the timer, you can do any of the following:

- slowly turn the timer dial in a counter clockwise direction until the desired time is reached, or
- remove AC adapter from power outlet and remove the adaptor from the Oster™ Wine Chiller.

USING YOUR WINE CHILLER (CONT.)

USING THE CONTINUOUS ON FEATURE

For chilling continuous beverages, simply turn the timer dial to the left. To stop chilling slowly turn the timer dial to the off position.

RECOMMENDED TIME AND ICE QUANTITIES

BEVERAGE	Ideal Drinking Approx. Temperature	Chilling Times with 2 Ice Trays	
		Warm Day Start Room Temp 25°C	Cool Day Start Room Temp 20°C
Pinot Grigio Sauvignon Blanc Riesling White Zinfandel	7-9°C	13 minutes	10 minutes
Chardonnay Burgundy (white) Beaujolais Nouveau Pinot Noir Burgundy (red) Beaujolais	10-12°C	9 ½ minutes	7 ½ minutes
Merlot Chianti	13-14°C	7 ½ minutes	5 ½ minutes
Cabernet Sauvignon Syrah / Shiraz Zinfandel (red) Port	17-18 °C	5 minutes	3 minutes

RECOMMENDED TIME AND ICE QUANTITIES (CONT.)

- Note:** Consecutive bottles can be chilled using the existing water, however this will slightly alter the chilling time.
- Tip:** The Oster™ Wine Chiller is also great for chilling bottles of soft drink and beer.
- Tip:** Older wines should be drunk at a couple of degrees warmer than younger wines.

CARE & CLEANING

When you have finished using your Oster™ Wine Chiller, unplug the AC adaptor from the power outlet and remove from the unit before cleaning.

To clean, simply wipe the outside and inside body of the Oster™ Wine Chiller with a damp cloth. Once clean, ensure that the appliance is dried thoroughly.

CAUTION: DO NOT IMMERSE APPLIANCE AND AC ADAPTER INTO LIQUIDS.

CARE & CLEANING (CONT.)

Removing and cleaning the agitating cover

Should a price label or any other packaging label peel off the bottle during chilling you may need to remove the agitating cover to retrieve the loose debris. To remove, simply lift out the black agitating cover, remove debris and wipe clean with a damp cloth. Ensure that once any loose debris has been removed that the agitating cover is replaced.

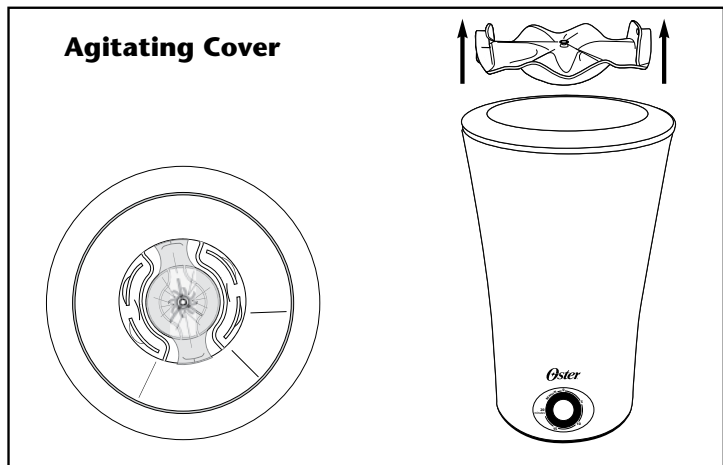

Note: Always unplug the Oster™ Wine Chiller before cleaning.

1 Year Limited Warranty

Sunbeam Products, Inc. doing business as Jarden Consumer Solutions or if in Canada, Sunbeam Corporation (Canada) Limited doing business as Jarden Consumer Solutions (collectively “JCS”) warrants that for a period of one year from the date of purchase, this product will be free from defects in material and workmanship. JCS, at its option, will repair or replace this product or any component of the product found to be defective during the warranty period. Replacement will be made with a new or remanufactured product or component. If the product is no longer available, replacement may be made with a similar product of equal or greater value. This is your exclusive warranty. Do NOT attempt to repair or adjust any electrical or mechanical functions on this product. Doing so will void this warranty.

This warranty is valid for the original retail purchaser from the date of initial retail purchase and is not transferable. Keep the original sales receipt. Proof of purchase is required to obtain warranty performance. JCS dealers, service centers, or retail stores selling JCS products do not have the right to alter, modify or any way change the terms and conditions of this warranty.

This warranty does not cover normal wear of parts or damage resulting from any of the following: negligent use or misuse of the product, use on improper voltage or current, use contrary to the operating instructions, disassembly, repair or alteration by anyone other than JCS or an authorized JCS service center. Further, the warranty does not cover: Acts of God, such as fire, flood, hurricanes and tornadoes.

What are the limits on JCS’s Liability?

JCS shall not be liable for any incidental or consequential damages caused by the breach of any express, implied or statutory warranty or condition.

Except to the extent prohibited by applicable law, any implied warranty or condition of merchantability or fitness for a particular purpose is limited in duration to the duration of the above warranty.

JCS disclaims all other warranties, conditions or representations, express, implied, statutory or otherwise.

JCS shall not be liable for any damages of any kind resulting from the purchase, use or misuse of, or inability to use the product including incidental, special, consequential or similar damages or loss of profits, or for any breach of contract, fundamental or otherwise, or for any claim brought against purchaser by any other party.

Some provinces, states or jurisdictions do not allow the exclusion or limitation of incidental or consequential damages or limitations on how long an implied warranty lasts, so the above limitations or exclusion may not apply to you.

This warranty gives you specific legal rights, and you may also have other rights that vary from province to province, state to state or jurisdiction to jurisdiction.

How to Obtain Warranty Service

In the U.S.A. –

If you have any question regarding this warranty or would like to obtain warranty service, please call 1.800.334.0759 and a convenient service center address will be provided to you.

In Canada –

If you have any question regarding this warranty or would like to obtain warranty service, please call 1.800.667.8623 and a convenient service center address will be provided to you.

In the U.S.A., this warranty is offered by Sunbeam Products, Inc. doing business as Jarden Consumer Solutions located in Boca Raton, Florida 33431. In Canada, this warranty is offered by Sunbeam Corporation (Canada) Limited doing business as Jarden Consumer Solutions, located at 20 B Hereford Street, Brampton, Ontario L6Y 0M1. If you have any other problem or claim in connection with this product, please write our Consumer Service Department.

PLEASE DO NOT RETURN THIS PRODUCT TO ANY OF THESE ADDRESSES OR TO THE PLACE OF PURCHASE.

Oster^{MC}

Pour toute question en ce qui concerne le produit, appelez le
service à la clientèle de Sunbeam

États-Unis: 1 800 334.0759

Canada: 1 800 667.8623

www.oster.ca

©2010 Sunbeam Products, Inc. faisant affaires sous le nom de
Jarden Consumer Solutions. Tous droits réservés. Importé et distribué par
Sunbeam Corporation, (Canada) Limited faisant affaires sous le nom de
Jarden Consumer Solutions, 20B Hereford St., Brampton ON Canada L6Y 0M1.