

Oster®

User Manual
Manual de Instrucciones
Manuel d'Instructions

BLENDER
LICUADORA
MÉLANGEUR

MODELS/MODELOS
MODELES **OSTER® BLSTDG SERIES**

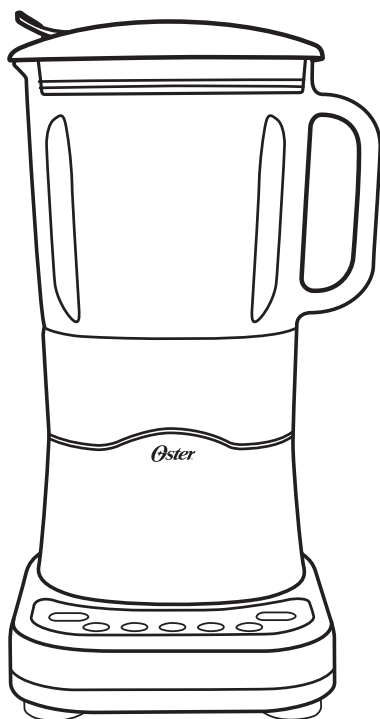

Visit us at www.oster.com

P.N. 135518

IMPORTANT SAFEGUARDS

When using electrical appliances, basic safety precautions should be followed, including the following:

READ ALL INSTRUCTIONS BEFORE USE

- Unplug cord from outlet when not in use or before cleaning.
- To protect against risk of electrical shock, do not immerse the cord, plug or motor base in water or any other liquids.
- Do not let cord hang over edge of table or counter or touch hot surfaces.
- Never leave appliance unattended when in use.
- Close supervision is necessary when used near children.
- Flashing Power Light indicates ready to operate. Avoid ANY contact with blades or moveable parts. Keep hands and utensils out of jar while blending to prevent personal injury or damage to the blender. A rubber spatula may be used only when the blender is not running.
- The blade is sharp. Handle with care.
- Always put the lid on the jar before operating the blender.
- Do not blend boiling liquids in the blender.
- When blending hot liquids, remove the flip-top spout cover from the lid. The steam from hot liquids may push lid off jar during blending. To prevent possible burns, do not fill jar beyond the 2 cup level. With the protection of oven mitt or towel, place one hand on top of lid. Keep exposed skin away from lid. Start blending at lowest speed.
- Do not operate any appliance with a damaged cord or plug, or after the appliance malfunctions or is dropped or damaged in any manner. Return the appliance to the nearest Authorized Sunbeam Appliance Service center for examination, repair or electrical or mechanical adjustment.
- Do not use outdoors or for commercial purposes; this appliance is for household use only.
- Use this appliance for its intended use as described in this manual. Do not use attachments that are not recommended by the manufacturer; they may cause injury.
- Always operate on a flat surface.
- Unplug the blender when it is not in use, before taking off or putting on parts and before cleaning.
- The use of attachments not made by OSTER® products, including canning or ordinary jar and processing assembly parts, is not recommended by Sunbeam Products, Inc., and may cause injury to persons.

THIS PRODUCT IS FOR HOUSEHOLD USE ONLY

The maximum rating marked on the product is based on the attachment that draws the greatest load. Other attachments may draw less power.

POWER CORD INSTRUCTIONS

Please follow the instructions below to ensure the safe use of the power cord.

- This appliance is equipped with a polarized plug. This type of plug has one blade that is wider than the other. This plug will fit in a polarized outlet only one way. This is a safety feature intended to help reduce the risk of electrical shock. If you are unable to insert the plug into the outlet, contact a qualified electrician to replace the obsolete outlet. Do not attempt to defeat the safety purpose of the polarized plug by modifying the plug in any way.
- You may use an extension cord, if necessary, but be certain to follow these guidelines:
 - The marked electrical rating of the extension cord must be at least 120/127 volt, 60 Hz, 10A.
 - The extension must be arranged so that it will not drape over the countertop or tabletop, will not be within the reach of children and will not be tripped over.
- Do not pull, twist or otherwise abuse the power cord.

SAVE THESE INSTRUCTIONS

WELCOME

Congratulations on your purchase of an OSTER® Blender!

To learn more about OSTER® products, please visit us at www.oster.com.

FEATURES OF YOUR BLENDER

- A. Pour through blender lid with flip-top spout cover
- B. Jar – Your Oster® Blender includes one of the following:
 - 7-Cup Dishwasher-Safe Glass Jar
 - 8-Cup Break-Resistant Plastic Jar
- C. Jar Skirt (*attached to jar*)
- D. Sealing Ring for tight seal
- E. Ice Crush Blade pulverizes ice for smooth frozen drinks
- F. Threaded Jar Nut
- G. Powerful Motor with ALL METAL DRIVE System for lasting durability
- H. Electronic Control Panel
- I. Pre-Programmed “Ice Crush” setting - pulses on high for 30 seconds with auto shut-off
- J. “Pulse” for precise blending control
- K. “High”, “Medium” and “Low” Speed Selections
- L. Pre-Programmed “Frozen Drinks” setting - runs on high for 45 seconds with auto shut-off
- M. ON/OFF will cease operation
- N. ON/OFF button flashes red when ready to operate

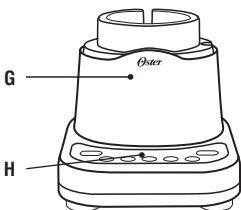
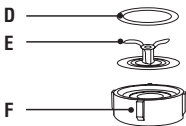
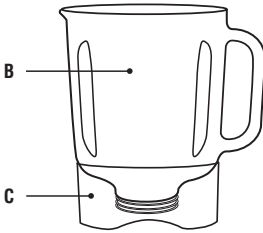
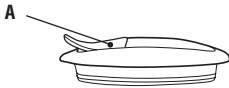

H

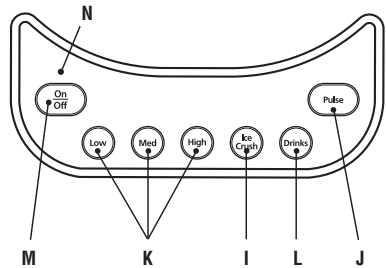

USING YOUR BLENDER

Clean blender according to the instructions in the “Cleaning and Storing Your Blender” section.

Jar assembly:

1. Turn jar upside down so the small opening is at the top. (*Figure 1*)
2. Place sealing ring over jar opening. (*Figure 1*)
3. Place blade into jar. (*Figure 2*)

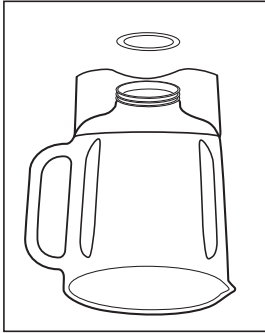

FIGURE 1

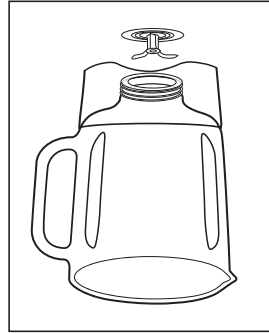

FIGURE 2



FIGURE 3

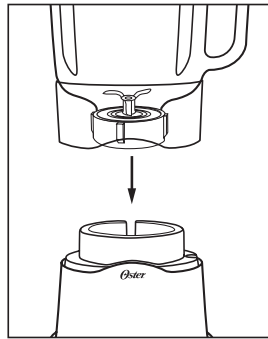

FIGURE 4

4. Place threaded jar nut over blade and jar. Place the threaded jar nut on jar and turn it clockwise to tighten. (*Figure 3*)
5. Place jar assembly onto base. (*Figure 4*)
6. Place ingredients into jar according to your recipe. For best results always add liquids first when blending.
7. Place pour through lid on jar.
8. Plug the power cord into a 120 Volt AC electrical outlet.
9. Touch the “POWER” button to turn the product on. The LED Indicator will flash red (and continue to flash) indicating it is ready to operate. You are now ready to blend. **Avoid contact with blades and moveable parts.**

JAR FEATURES

Your new blender features a uniquely shaped oval jar that is designed to fit in most refrigerator doors for convenient storage of drinks. This new jar design creates a figure eight vortex ensuring that all ingredients are blended efficiently for outstanding drink results.

Your new blender is equipped with a pitcher-style, flip-top lid so you don't have to remove the lid for pouring.

SPEED MODES: LOW, MEDIUM, HIGH

- To blend in High Speed, press the “HIGH” button.
- To blend in Medium Speed, press the “MED” button.
- To blend in Low Speed, press the “LOW” button.
- To Stop blending, press the “ON/OFF” button. The motor will come to a stop. (Pressing the “ON/OFF” button stops the motor and turns off the blender.)
- You can move between speeds at any time while blending by pressing any of the other speed buttons. The new speed will start without interruption.
- Pressing the “PULSE” Button will give a momentary pulse at high speed. The motor will then stop.

NOTE: Pressing the “ICE CRUSH or DRINKS” or the Speed button at which it is blending will also stop the motor.

PRE-PROGRAMMED SETTINGS

**Your new blender features 2 Pre-Programmed Settings:
“Ice Crush” and “Drinks”.**

- The “ICE CRUSH” setting is ideal for crushing larger quantities of ice. The “ICE CRUSH” mode pulses between high and off for 30 seconds and will automatically shut off at the end of the cycle.
- The “DRINKS” setting is designed for perfectly blended frozen drinks. The “DRINKS” setting runs on high speed for 45 seconds and will automatically shut off at the end of the cycle.
- To stop blending in either of these settings, press the “ON/OFF” button. The motor will come to a stop. (pressing the “ON/OFF” button stops the motor and turns the blender off.)
- Pressing the “PULSE” button will give a momentary pulse at high speed. The motor will then stop.

TO USE THE PULSE SETTING

The “PULSE” button momentarily activates the blender at HIGH speed. You may also continuously touch the “PULSE” button to pulse as desired.

- To Pulse, press the “PULSE” button to activate a momentary high speed. The blender will run at high speed as long as you press the button. The motor will stop when you stop pressing the button.

BLENDING TIPS

- Working with Hot Foods or Liquids:

(!!) **WARNING:** When you work with HOT FOODS, flip the jar lid open to vent steam. Partially cover the opening keeping hands and other exposed skin away from the lid opening to prevent possible burns. (Figure 6)

(!!) **WARNING:** When you work with HOT LIQUIDS, flip the jar lid open and start at a low speed, and gradually increase to a faster speed. Do not add liquid over the 2 cup (.5L) level. Always keep hands and exposed skin away from steam. Start blending at lowest speed. (Figure 6)

- Put liquids in the jar first, unless a recipe says otherwise.
- Crushing ice: Crush approximately 3 cups of ice at a time with 2 cups of liquid for optimal results.
- Do not remove the lid while in use. Flip the jar lid open to add smaller ingredients. (Figure 6)
- This blender has been designed to gently process foods when operating at low speeds. If blades do not rotate during operation, simply choose a higher speed.
- This blender will not mash potatoes, whip egg whites or substitute dairy toppings, mix stiff dough or grind raw meat.

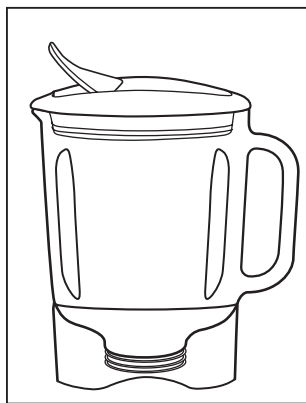

FIGURE 6

CLEANING AND STORING YOUR BLENDER

IMPORTANT: Unplug Before Cleaning Base And Do Not Immerse The Blender Base In Water Or Any Other Liquids.

Use a damp, soft sponge with mild detergent to clean the outside of the blender base and control panel. All parts except for the blender base are dishwasher safe. Place sealing ring in bottom basket of dishwasher. You can also wash the parts in warm, soapy water. Rinse well and dry.

STORING YOUR BLENDER

After cleaning, reassemble blade to jar with sealing ring and threaded jar bottom. Store blender with cover ajar to prevent container odor.

RECIPES

For fun and creative recipes for your new Oster® blender please visit www.oster.com. Here you will find everything from the perfect Breakfast Smoothie to creamy Soups, Sauces and a host of Oster® signature Frozen Drinks. For the perfect recipe for any occasion — turn on your creativity with Oster®!

GINGER PEACH SMOOTHIE

MAKES CUPS	YOGURT (OUNCES)	ICE CUBES MEDIUM	FROZEN SLICED PEACHES	FROZEN BANANA (2 INCH CHUNKS)	WHITE GRAPE JUICE (OUNCES)	GROUND GINGER (TSP)
2	8	2	5	2	3	1/8
3	12	3	8	3	4 1/2	1/5
4	16	4	10	4	6	1/4
5	20	5	13	5	7 1/2	1/3
6	24	6	15	6	9	3/8
7	28	7	18	7	10 1/2	1/2
8	32	8	20	8	12	1/2

STRAWBERRY SMOOTHIE

MAKES CUPS	YOGURT (OUNCES)	ICE CUBES MEDIUM	FROZEN STRAWBERRIES (1 INCH DIA. MAX)	FROZEN BANANA (2 INCH CHUNKS)	WHITE GRAPE JUICE (OUNCES)	GROUND GINGER (TSP)
2	7	2	2	2	3	1/8
3	11	3	3	3	4 1/2	1/5
4	14	4	4	4	6	1/4
5	18	5	5	5	7 1/2	1/3
6	21	6	6	6	9	3/8
7	25	7	7	7	10 1/2	1/2
8	28	8	8	8	12	1/2

RECIPES

VANILLA MILKSHAKE

MAKES CUPS	ICE CREAM CUPS	MILK OUNCES	VANILLA TSP
2	2	6	1/8
3	3	9	1/4
4	4	12	1/4
5	5	15	3/8
6	6	18	3/8
7	7	21	1/2
8	8	24	1/2

MARGARITA

MAKES CUPS	TEQUILA OUNCES	MARGARITA MIX OUNCES	ICE CUPS
2	2	6	1 1/2
3	3	9	2 1/2
4	4	12	3
5	5	15	4
6	5 1/2	18	5
7	6 1/2	21	5 1/2
8	7 1/2	24	6 1/2

1-Year Limited Warranty

Sunbeam Products, Inc. doing business as Jarden Consumer Solutions or if in Canada, Sunbeam Corporation (Canada) Limited doing business as Jarden Consumer Solutions (collectively “JCS”) warrants that for a period of one year from the date of purchase, this product will be free from defects in material and workmanship. JCS, at its option, will repair or replace this product or any component of the product found to be defective during the warranty period. Replacement will be made with a new or remanufactured product or component. If the product is no longer available, replacement may be made with a similar product of equal or greater value. This is your exclusive warranty. Do NOT attempt to repair or adjust any electrical or mechanical functions on this product. Doing so will void this warranty.

This warranty is valid for the original retail purchaser from the date of initial retail purchase and is not transferable. Keep the original sales receipt. Proof of purchase is required to obtain warranty performance. JCS dealers, service centers, or retail stores selling JCS products do not have the right to alter, modify or any way change the terms and conditions of this warranty.

This warranty does not cover normal wear of parts or damage resulting from any of the following: negligent use or misuse of the product, use on improper voltage or current, use contrary to the operating instructions, disassembly, repair or alteration by anyone other than JCS or an authorized JCS service center. Further, the warranty does not cover: Acts of God, such as fire, flood, hurricanes and tornadoes.

What are the limits on JCS’s Liability?

JCS shall not be liable for any incidental or consequential damages caused by the breach of any express, implied or statutory warranty or condition.

Except to the extent prohibited by applicable law, any implied warranty or condition of merchantability or fitness for a particular purpose is limited in duration to the duration of the above warranty.

JCS disclaims all other warranties, conditions or representations, express, implied, statutory or otherwise.

JCS shall not be liable for any damages of any kind resulting from the purchase, use or misuse of, or inability to use the product including incidental, special, consequential or similar damages or loss of profits, or for any breach of contract, fundamental or otherwise, or for any claim brought against purchaser by any other party.

Some provinces, states or jurisdictions do not allow the exclusion or limitation of incidental or consequential damages or limitations on how long an implied warranty lasts, so the above limitations or exclusion may not apply to you.

This warranty gives you specific legal rights, and you may also have other rights that vary from province to province, state to state or jurisdiction to jurisdiction.

How to Obtain Warranty Service

In the U.S.A.

If you have any question regarding this warranty or would like to obtain warranty service, please call 1-800-334-0759 and a convenient service center address will be provided to you.

In Canada

If you have any question regarding this warranty or would like to obtain warranty service, please call 1-800-667-8623 and a convenient service center address will be provided to you.

In the U.S.A., this warranty is offered by Sunbeam Products, Inc. doing business as Jarden Consumer Solutions located in Boca Raton, Florida 33431. In Canada, this warranty is offered by Sunbeam Corporation (Canada) Limited doing business as Jarden Consumer Solutions, located at 20 B Hereford Street, Brampton, Ontario L6Y 0M1. If you have any other problem or claim in connection with this product, please write our Consumer Service Department.

PLEASE DO NOT RETURN THIS PRODUCT TO ANY OF THESE ADDRESSES OR TO THE PLACE OF PURCHASE.



For product questions contact:

Jarden Consumer Service

USA: 1.800.334.0759

Canada: 1-800-667-8623

www.oster.com

©2009 Sunbeam Products, Inc. doing business as Jarden Consumer Solutions.

All rights reserved. Distributed by Sunbeam Products, Inc.

doing business as Jarden Consumer Solutions, Boca Raton, Florida 33431.

SPR-062509

Para preguntas sobre los productos llame:

Jarden Consumer Service

EE.UU.: 1.800.334.0759

Canadá: 1-800-667-8623

www.oster.com

©2009 Sunbeam Products, Inc. operando bajo el nombre de

Jarden Consumer Solutions. Todos los derechos reservados.

Distribuido por Sunbeam Products, Inc. operando bajo el nombre de

Jarden Consumer Solutions, Boca Raton, Florida 33431.

Pour les questions de produit:

Jarden Consumer Service

États-Unis : 1.800.334.0759

Canada : 1-800-667-8623

www.oster.com

© 2009 Sunbeam Products, Inc. faisant affaires sous le nom de
Jarden Consumer Solutions. Tous droits réservés. Distribué Sunbeam Products, Inc.

faisant affaires sous le nom de Jarden Consumer Solutions,

Boca Raton, Florida 33431.